

# HD 280 PRO



Quick Guide  
Kurzanleitung  
Guide rapide  
Guida rapida

Instrucciones resumidas  
Beknopte handleiding  
Краткая инструкция  
快速指南

 **SENNHEISER**

Further information | Weitere Informationen |  
Autre information | Altra informazione |  
Información adicional | Niederländisch |  
Russisch | Chinesisch



## In the box

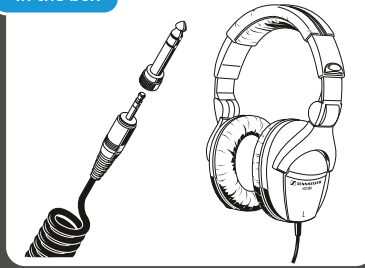

## Adjusting

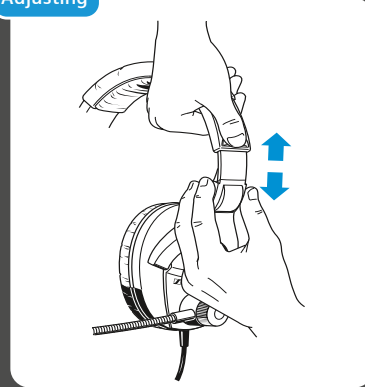

## Folding up the headphones

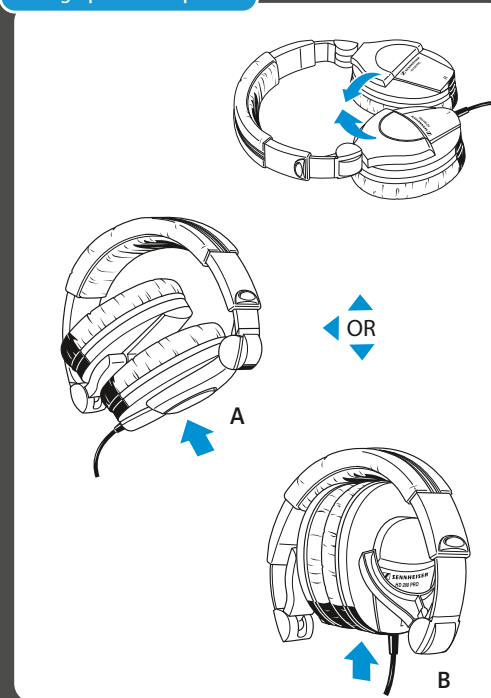

## Replacing spare parts

### Headband padding

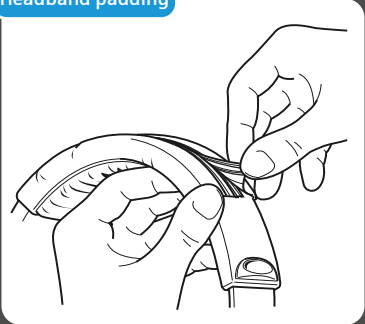

### Ear cushions

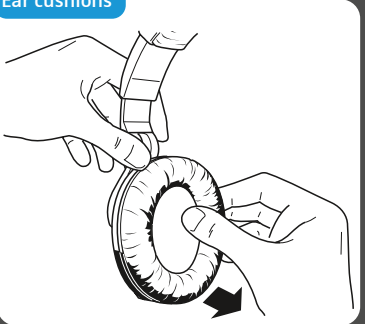

## Specifications

### Headphone HD 280 PRO

Acoustic principle	dynamic, closed
Impedance	64 $\Omega$
Ear coupling	circumaural
Frequency response (-10 dB at 1 kHz)	8 - 25,000 Hz
Ambient noise attenuation	max. 32 dB
THD	<0.1% (at 1 kHz, 100 dB SPL)
Weight (w/o cable)	approx. 220 g
Contact pressure	approx. 6 N
Length of coiled cable	min. 1 m / max. 3 m
Temperature	10 °C to 70 °C

Sennheiser electronic GmbH & Co. KG

Am Labor 1, 30900 Wedemark, Germany  
www.sennheiser.com

Printed in Germany, Publ. 01/16, 566630/A01